

Beam & Girder Clamps

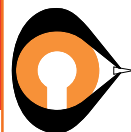

The Caldwell Group • 800-628-4263 Fax 815-229-5686
Rig-Master® Section
Master Catalog MC-607

Model BFC - Beam Flange Clamp

IN-STOCK PROGRAM



LARGE BAIL OPTION



PRODUCT FEATURES:

- Rated load capacities from 1 to 5 tons.
- Light weight and portable design.
- Left-hand thread and right-hand thread screw spindle allows for rapid clamping and unclamping.
- Jaw aperture adjusts to a wide range of beam types and flange widths.
- Built-in suspension pin provides lower headroom.
- Available with Large Bail option for oversized hoist hooks.
- Designed and manufactured to ASME B30.20

SPECIFICATIONS

Model Number	Rated Capacity Tons	Dimensions in Inches											Weight (lbs.)	
		A*		B Max.	C	D		E	F Dia.	G	Option LB			
		Min.	Max.			Min.	Max.				H	I		T
BFC - 1	1	3	7 1/2	10 1/2	3	3 3/4	4 1/2	7	7/8	2 1/4	3 1/2	2	5/8	8
BFC - 2 1/2	2 1/2	3	7 1/2	10 1/2	3	3 3/4	4 1/2	7	7/8	2 1/8	3 1/2	2	5/8	9
BFC - 5	5	6	12	15	4 1/2	4 5/8	6 3/8	9 1/2	1 3/8	2 3/8	4	2 1/2	1	18

*Maximum Beam Flange Thickness 1" - All Sizes

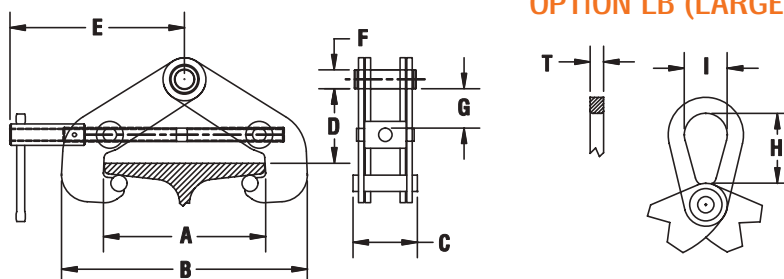

OPTION LB (LARGE BAIL)

Applications



Allows for the capability of hanging hoists or rigging from an overhead load bearing structure

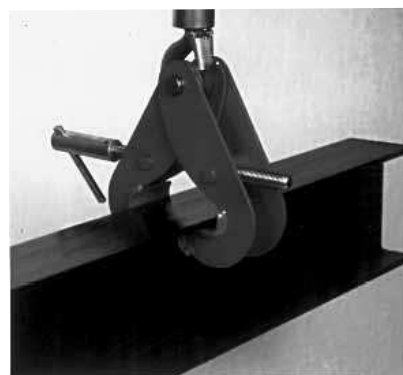

For lifting and/or positioning structural beams. Can be used in pairs in conjunction with a spreader beam for additional versatility